

Joining Plates provide a simple and economical method for connecting extrusion profiles without drilling or tapping. Attachment can be made inline, at right angles or at 45° angles.

Material: 6061-T6 Aluminum Alloy, Clear Anodized

Part No.	Attachment	Profiles	Weight, kg (lb)
ESJ2800	Inline	28 x 28 and 40 x 40	.01 (.03)
ESJ2810	Right angle	Two 28 x 28	.04 (.09)
ESJ2812	"T"	Two 28 x 28	.04 (.09)
ESJ4000	Inline or right angle	Two 40 x 40	.05 (.10)
ESJ4002	Double inline or right angle	Two 40 x 40 or two 40 x 80	.09 (.20)
ESJ4010	Right angle	Two 40 x 40 or two 40 x 80	.17 (.38)
ESJ4012	"T"	Two 40 x 40 or two 40 x 80	.17 (.38)
ESJ8000	Inline or right angle	Two 40 x 80	.10 (.21)
ESJ8002	Inline or right angle	Two 40 x 80 or two 80 x 80	.20 (.43)
ESJ8010	Right angle	Two 40 x 80 or two 80 x 80	.36 (.79)
ESJ8012	"T"	Two 40 x 80 or two 80 x 80	.36 (.79)

RECOMMENDED FASTENERS

For Part Number ESJ2800

Metric
(1) ESF4008-18 BHSCS (2) ESF4008-16 BHSCS (2) ESF1008 Flat Washer (3) ESF3008A Standard T-Nut

For Part Numbers ESJ2810 and ESJ2812
(all quantities as required per number of holes)

Metric
ESF4008-10 BHSCS ESF3008A Standard T-Nut

For Part Numbers ESJ40 and ESJ80 ****
(all quantities as required per number of holes)

1) Button Head Cap Screw Method

Metric
ESF4008-18 BHSCS ESF3008 Standard T-Nut or ESF3208 Drop In T-Nut

2) T-Slot Stud Method

Metric
ESF4208-20 T-Slot Stud ESF1008 Flat Washer ESF3308 Hex Nut

For 28 mm Profiles

Part No. ESJ2800

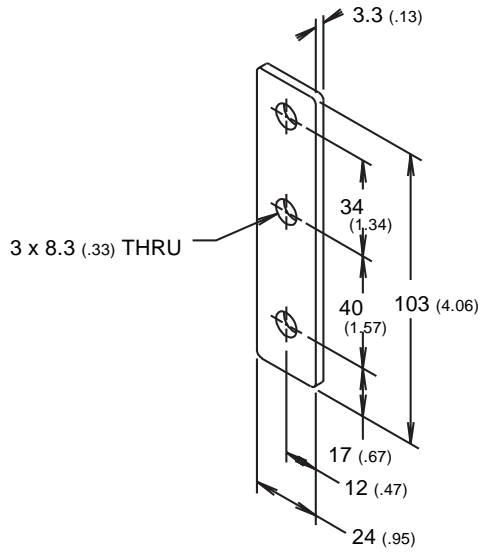

B Connectors

Part No. ESJ2810

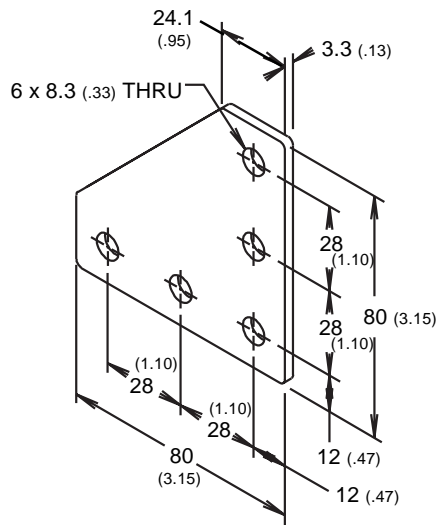

Part No. ESJ2812

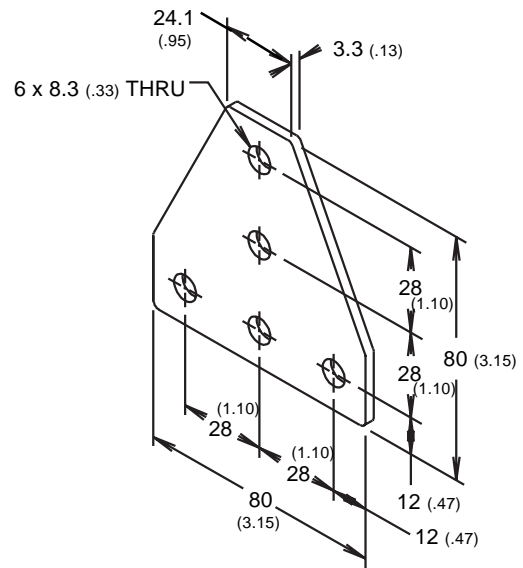

Note: All dimensions in mm (in)

For 40 mm Profiles

Part No. ESJ4000

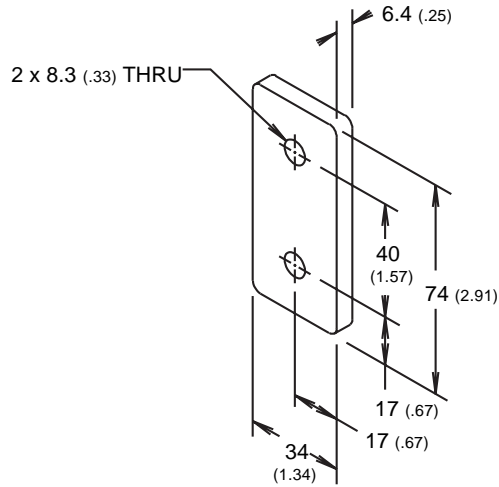

Part No. ESJ4002

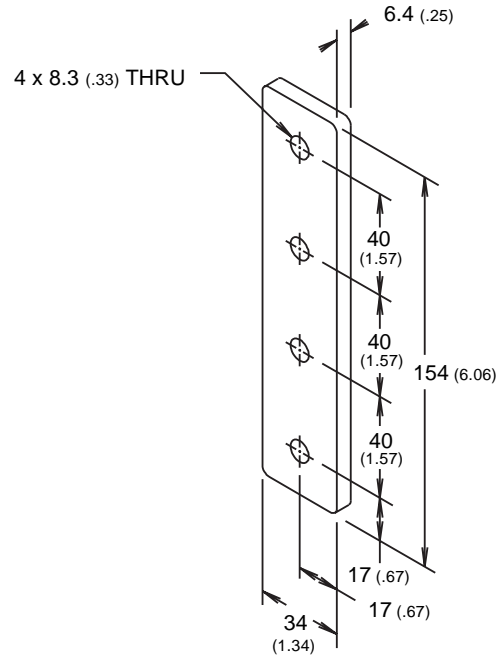

Part No. ESJ4010

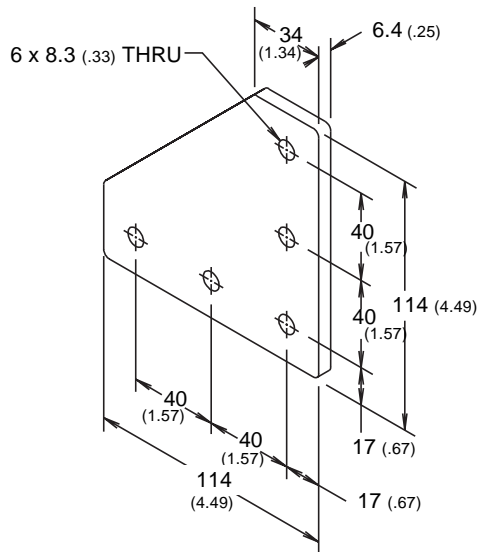

Part No. ESJ4012

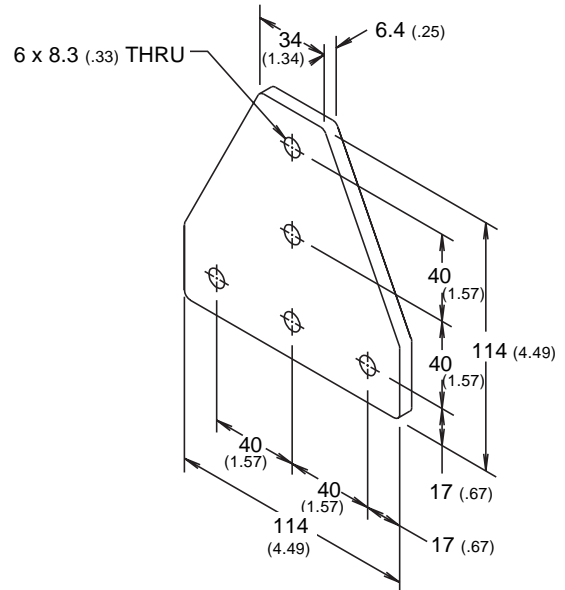

Note: All dimensions in mm (in)

For 80 mm Profiles

Part No. ESJ8000

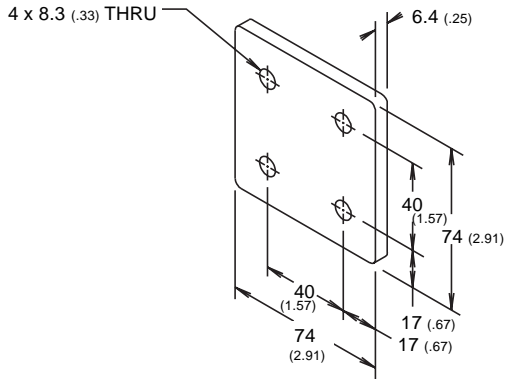

Part No. ESJ8002

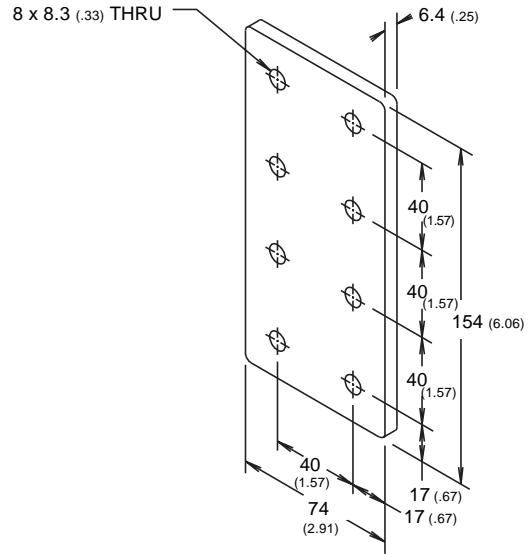

Part No. ESJ8010

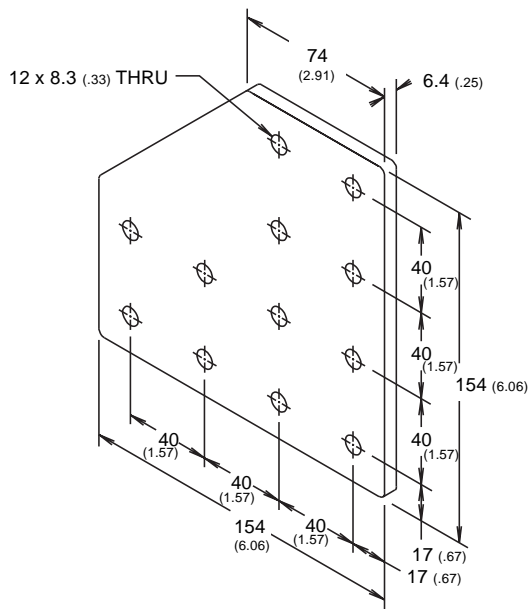

Part No. ESJ8012

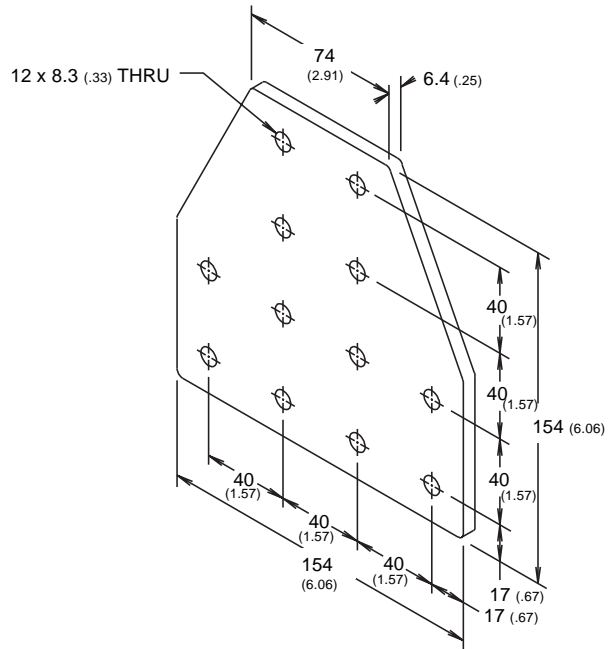

Note: All dimensions in mm (in)

The T-Slot Stud provides a very high strength and vibration resistant connection when used in mounting accessories such as joining plates. This fastener must be installed into the T-slot from an open end of the extrusion profile.

Material: Zinc Plated Carbon Steel

Note: Consult factory for use with 28 profiles.

Part No.	Description	Weight	
		kg	lb
ESF4208-20	M8 x 20	0.01	0.03
ESF4208-25	M8 x 25	0.02	0.04
ESF4208-30	M8 x 30	0.02	0.04
ESF4208-35	M8 x 35	0.02	0.04
ESF4208-45	M8 x 45	0.02	0.05
ESF4208-50	M8 x 50	0.02	0.05



B Connectors

**Button Head Socket Cap Screws
Metric**

Material: Zinc Plated Carbon Steel (Metric)

Part No.	Description	Weight	
		kg	lb
ESF4005-10	M5 x 10 (mm)	0.002	0.005
ESF4005-12	M5 x 12	0.002	0.005
ESF4005-16	M5 x 16	0.002	0.005
ESF4006-08	M6 x 8	0.002	0.005
ESF4006-10	M6 x 10	0.002	0.005
ESF4006-12	M6 x 12	0.002	0.005
ESF4006-16	M6 x 16	0.005	0.01
ESF4006-20	M6 x 20	0.005	0.01
ESF4008-10	M8 x 10	0.007	0.015
ESF4008-12	M8 x 12	0.007	0.015
ESF4008-16	M8 x 16	0.009	0.02
ESF4008-18	M8 x 18	0.009	0.02
ESF4008-20	M8 x 20	0.009	0.02
ESF4008-25	M8 x 25	0.011	0.025
ESF4008-30	M8 x 30	0.011	0.025
ESF4008-35	M8 x 35	0.012	0.027
ESF4008-45	M8 x 45	0.016	0.035
ESF4010-20	M10 x 20	0.016	0.035

**Socket Head Cap Screws
Metric**

Material: Zinc Plated Carbon Steel (Metric)

Part No.	Description	Weight	
		kg	lb
ESF4106-12	M6 x 12 (mm)	0.005	0.01
ESF4106-16	M6 x 16	0.005	0.01
ESF4106-20	M6 x 20	0.007	0.015
ESF4106-25	M6 x 25	0.009	0.02
ESF4106-30	M6 x 30	0.011	0.025
ESF4106-45	M6 x 45	0.017	0.037
ESF4108-12	M8 x 12	0.009	0.02
ESF4108-16	M8 x 16	0.011	0.025
ESF4108-20	M8 x 20	0.011	0.025
ESF4108-25	M8 x 25	0.014	0.03
ESF4108-30	M8 x 30	0.017	0.037
ESF4108-45	M8 x 45	0.023	0.051

**Hex Nuts & Washers
Metric**

Material: Zinc Plated Carbon Steel

Part No.	Description	Weight	
		kg	lb
ESF3306	M6 Hex Nut	0.002	0.005
ESF3308	M8 Hex Nut	0.005	0.01
ESF1004	M4 Flat Washer	0.001	0.001
ESF1006	M6 Flat Washer	0.001	0.001
ESF1008	M8 Flat Washer	0.002	0.005
ESF1010	M10 Flat Washer	0.002	0.005
ESF1106	M6 Lock Washer	0.001	0.001
ESF1108	M8 Lock Washer	0.002	0.005
ESF1110	M10 Lock Washer	0.002	0.005

The economy T-Nut is the most economical method of fastening, and provides a high strength connection. This nut must be installed into the T-slot from an open end of the extrusion profile.

Material: Zinc Plated Carbon Steel

Assembly Tip: Insert economy T-nuts into the T-slot before final installation of accessories.

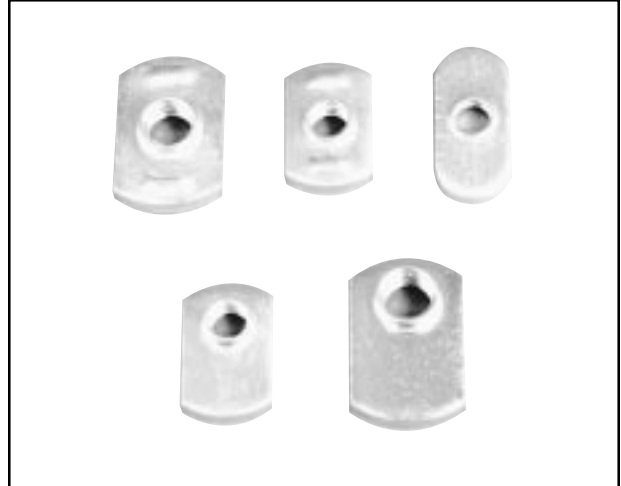

B Connectors

Part No.	A	B		C		D		E		Weight		Tapped Hole Position	For use with 28 & 56 Profiles	For use with 40 & 80 Profiles
		mm	in	mm	in	mm	in	mm	in	kg	lb			
ESF3004	M4	11.00	0.43	11.00	0.43	22.00	0.87	3.50	0.14	0.005	0.01	Centered	X	X
ESF3005	M5	11.00	0.43	11.00	0.43	22.00	0.87	3.50	0.14	0.005	0.01	Centered	X	X
ESF3006	M6	13.00	0.51	6.50	0.26	20.50	0.81	4.50	0.18	0.005	0.01	Offset	X	X
ESF3008	M8	16.00	0.63	7.00	0.28	25.00	0.87	5.80	0.23	0.009	0.02	Offset		X
ESF3008A	M8	13.00	0.51	10.30	0.41	20.50	0.81	5.40	0.21	0.005	0.01	Centered	X	

T-Nut with Center Hole Position

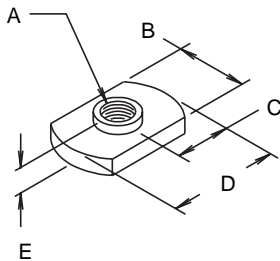

T-Nut with Offset Hole Position

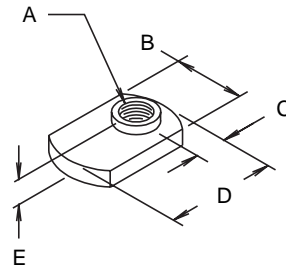

Note: All dimensions in mm (in)

The Drop In T-Nut has a unique profile which allows it to be inserted into the T-slot at any point along an extrusion profile. This feature is useful when adding hardware to an existing assembly where the ends of the profile are not accessible.

As an added benefit, the rubber tip can be used to drag the nut into place. Furthermore, a rubber tip provides a friction hold so that the T-nut remains fixed in place. This is especially important in vertical profiles.

Material: Zinc Plated Carbon Steel

Weight: .009 kg (.02 lb)

Part No.	T-Nut Thread	Profiles
ESF3204	M4	40 & 80
ESF3205	M5	40 & 80
ESF3206	M6	40 & 80
ESF3606	M6	28 & 56
ESF3208	M8	40 & 80

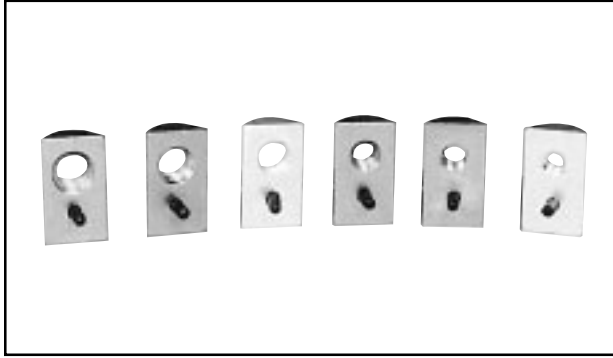
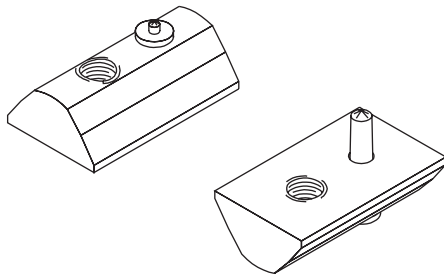

B Connectors

